

PLAN VIEW

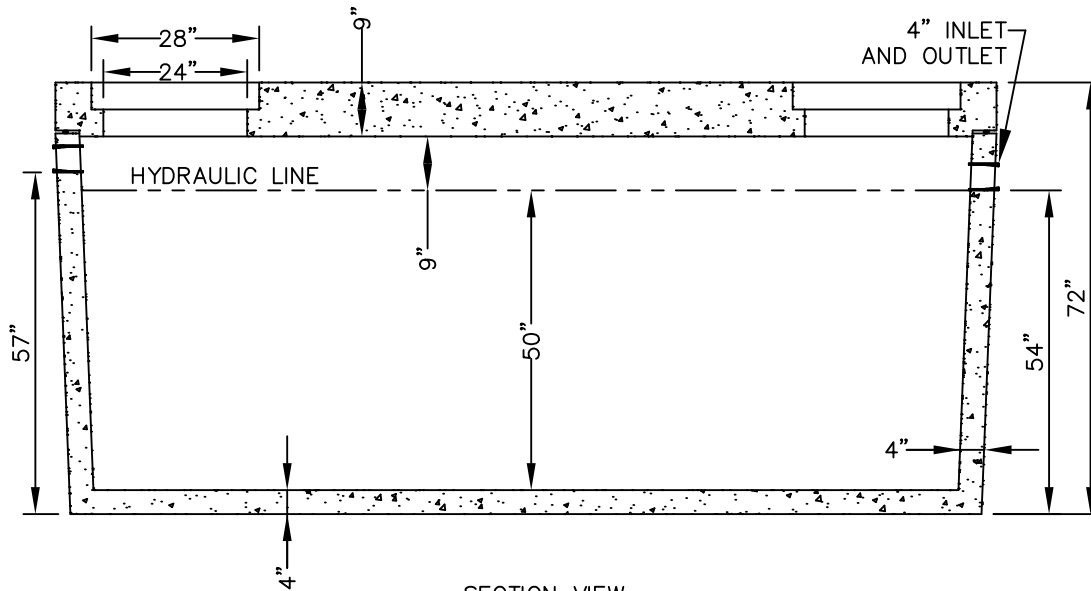

SECTION VIEW

SPECIFICATIONS

CONCRETE TO 5000PSI @ 28 DAYS

REINFORCEMENT TO ASTM A-615 GRADE 60

TOP SLAB:

#5 @ 6" O/C SHORT WAY

#4 @ 10" O/C LONG WAY

HS-20 TRAFFIC RATED TOP SLAB

MAX FILL HEIGHT NOT TO EXCEED 3' ABOVE TOP SLAB

4" RUBBER GASKET SEALS PROVIDED INLET & OUTLET

STEEL H-20 RATED FRAME AND COVERS INCLUDED

INTERNAL BAFFLE CONFIGURATION AS PER SPECS.

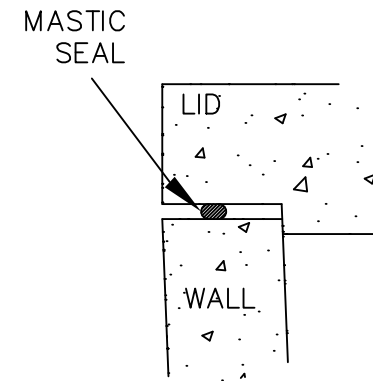

SEAL DETAIL

THIS DOCUMENT MAY NOT BE DISTRIBUTED, MODIFIED, ALTERED, OR REPRODUCED IN WHOLE OR IN PART WITHOUT THE PRIOR WRITTEN PERMISSION OF MARYLAND CONCRETE SEPTIC TANK INC.

REVISION	SIGNOFF
Number	Date Initial
1	
2	
3	
4	
5	
6	
7	
8	

**Maryland Concrete Inc.**

2000 GALLON SINGLE COMPARTMENT GREASE TRAP WITH LOAD BEARING LID

---

DRAWN: TLG 6/28/13

CHECKED:

SCALE: AS SHOWN

**No. MC086.1**

3			
2			
1			
0	9/4/13	ISSUED FOR CONSTRUCTION	JMH / TLG
	DATE	REVISION DESCRIPTION	DESIGNER/CHECKER